

⚠ Safety Instructions

Read these instructions carefully before commencing installation and retain for future reference. The luminaire should be installed by a licensed electrician and in accordance with local regulations. Make sure that the power is off before installation. Install as described below.

Product Information:

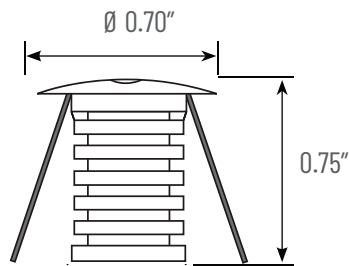

Hole cutout - Ø0.63 (5/8")

Installation Instructions

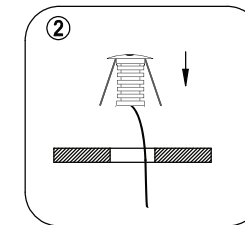
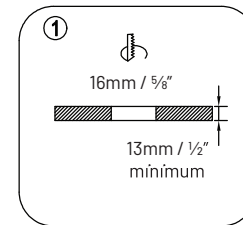

Wiring:

1. This LED luminaire must be connected to a constant voltage driver 12VDC in parallel.
WARNING! Incorrect connection may damage the luminaire.
2. Note the dimension requirements before installation.
3. The light emitted from an LED luminaire is strong, avoid looking directly into the light source.
4. Connect the LED luminaire to the driver before turning on the power to the driver.

